



Morse e tavole per macchina • **Fissaggio e staffaggio** • Magneti • Mandrini idraulici e mandrini a forte serraggio • Mandrini HSK • Mandrini DIN ISO 7388-1 (ex DIN 69871) • Mandrini MAS-BT • Mandrini DIN 2080 • Pinze di serraggio ER • Accessori per mandrini • Codoli per mandrini • Teste ad angolo e moltiplicatori • Calettamento, bilanciatura e presetting • Tastatori e centratori • Schermi di protezione • Sbvatori • Lampade • Marcatura



### Vite per cave a T

Vite per cave a T, in acciaio 42CrMoS4, **classe 10.9**, filettatura rollata.

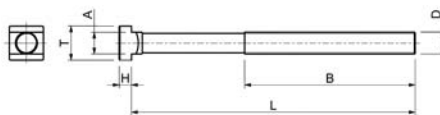

| Codice     | €   | D   | L (mm) | B (mm) | A (mm) | T (mm) | H (mm) | Cava (mm) |
|------------|-----|-----|--------|--------|--------|--------|--------|-----------|
| C601100005 | --- | M10 | 40     | 30     | 9,7    | 15     | 6      | 10        |
| C601100010 | --- | M10 | 63     | 45     | 9,7    | 15     | 6      | 10        |
| C601100015 | --- | M10 | 80     | 55     | 9,7    | 15     | 6      | 10        |
| C601100020 | --- | M10 | 100    | 60     | 9,7    | 15     | 6      | 10        |
| C601100025 | --- | M10 | 125    | 75     | 9,7    | 15     | 6      | 10        |
| C601100030 | --- | M10 | 150    | 100    | 9,7    | 15     | 6      | 10        |
| C601100035 | --- | M10 | 170    | 100    | 9,7    | 15     | 6      | 10        |
| C601100040 | --- | M12 | 50     | 35     | 11,7   | 18     | 7      | 12        |
| C601100045 | --- | M12 | 63     | 45     | 11,7   | 18     | 7      | 12        |
| C601100050 | --- | M12 | 80     | 55     | 11,7   | 18     | 7      | 12        |
| C601100055 | --- | M12 | 100    | 60     | 11,7   | 18     | 7      | 12        |
| C601100060 | --- | M12 | 125    | 75     | 11,7   | 18     | 7      | 12        |
| C601100065 | --- | M12 | 150    | 100    | 11,7   | 18     | 7      | 12        |
| C601100070 | --- | M12 | 170    | 100    | 11,7   | 18     | 7      | 12        |
| C601100075 | --- | M12 | 200    | 120    | 11,7   | 18     | 7      | 12        |
| C601100080 | --- | M14 | 63     | 40     | 13,7   | 22     | 8      | 14        |
| C601100085 | --- | M14 | 80     | 55     | 13,7   | 22     | 8      | 14        |
| C601100090 | --- | M14 | 100    | 65     | 13,7   | 22     | 8      | 14        |
| C601100095 | --- | M14 | 125    | 75     | 13,7   | 22     | 8      | 14        |
| C601100100 | --- | M14 | 150    | 100    | 13,7   | 22     | 8      | 14        |
| C601100105 | --- | M14 | 170    | 100    | 13,7   | 22     | 8      | 14        |
| C601100110 | --- | M14 | 200    | 125    | 13,7   | 22     | 8      | 14        |
| C601100115 | --- | M14 | 230    | 150    | 13,7   | 22     | 8      | 14        |
| C601100120 | --- | M16 | 63     | 45     | 15,7   | 25     | 9      | 16        |
| C601100125 | --- | M16 | 80     | 55     | 15,7   | 25     | 9      | 16        |
| C601100130 | --- | M16 | 100    | 63     | 15,7   | 25     | 9      | 16        |
| C601100135 | --- | M16 | 125    | 75     | 15,7   | 25     | 9      | 16        |
| C601100140 | --- | M16 | 150    | 100    | 15,7   | 25     | 9      | 16        |
| C601100145 | --- | M16 | 160    | 100    | 15,7   | 25     | 9      | 16        |
| C601100150 | --- | M16 | 170    | 100    | 15,7   | 25     | 9      | 16        |
| C601100155 | --- | M16 | 200    | 125    | 15,7   | 25     | 9      | 16        |
| C601100160 | --- | M16 | 230    | 150    | 15,7   | 25     | 9      | 16        |
| C601100165 | --- | M16 | 250    | 150    | 15,7   | 25     | 9      | 16        |

| Codice     | €   | D   | L (mm) | B (mm) | A (mm) | T (mm) | H (mm) | Cava (mm) |
|------------|-----|-----|--------|--------|--------|--------|--------|-----------|
| C601100170 | --- | M18 | 80     | 55     | 17,7   | 28     | 10     | 18        |
| C601100175 | --- | M18 | 100    | 65     | 17,7   | 28     | 10     | 18        |
| C601100180 | --- | M18 | 125    | 85     | 17,7   | 28     | 10     | 18        |
| C601100185 | --- | M18 | 150    | 100    | 17,7   | 28     | 10     | 18        |
| C601100190 | --- | M18 | 170    | 100    | 17,7   | 28     | 10     | 18        |
| C601100195 | --- | M18 | 200    | 125    | 17,7   | 28     | 10     | 18        |
| C601100200 | --- | M18 | 230    | 150    | 17,7   | 28     | 10     | 18        |
| C601100205 | --- | M20 | 80     | 55     | 19,7   | 32     | 12     | 20        |
| C601100210 | --- | M20 | 100    | 63     | 19,7   | 32     | 12     | 20        |
| C601100215 | --- | M20 | 125    | 85     | 19,7   | 32     | 12     | 20        |
| C601100220 | --- | M20 | 150    | 100    | 19,7   | 32     | 12     | 20        |
| C601100225 | --- | M20 | 160    | 110    | 19,7   | 32     | 12     | 20        |
| C601100230 | --- | M20 | 170    | 100    | 19,7   | 32     | 12     | 20        |
| C601100235 | --- | M20 | 200    | 125    | 19,7   | 32     | 12     | 20        |
| C601100240 | --- | M20 | 230    | 150    | 19,7   | 32     | 12     | 20        |
| C601100245 | --- | M20 | 315    | 190    | 19,7   | 32     | 12     | 20        |
| C601100250 | --- | M22 | 80     | 55     | 21,7   | 35     | 14     | 22        |
| C601100255 | --- | M22 | 100    | 63     | 21,7   | 35     | 14     | 22        |
| C601100260 | --- | M22 | 125    | 85     | 21,7   | 35     | 14     | 22        |
| C601100265 | --- | M22 | 150    | 100    | 21,7   | 35     | 14     | 22        |
| C601100270 | --- | M22 | 170    | 100    | 21,7   | 35     | 14     | 22        |
| C601100275 | --- | M22 | 200    | 125    | 21,7   | 35     | 14     | 22        |
| C601100280 | --- | M22 | 230    | 150    | 21,7   | 35     | 14     | 22        |
| C601100285 | --- | M24 | 80     | 55     | 23,7   | 40     | 16     | 24        |
| C601100290 | --- | M24 | 100    | 70     | 23,7   | 40     | 16     | 24        |
| C601100295 | --- | M24 | 125    | 85     | 23,7   | 40     | 16     | 24        |
| C601100300 | --- | M24 | 150    | 100    | 23,7   | 40     | 16     | 24        |
| C601100305 | --- | M24 | 160    | 110    | 23,7   | 40     | 16     | 24        |
| C601100310 | --- | M24 | 170    | 100    | 23,7   | 40     | 16     | 24        |
| C601100315 | --- | M24 | 200    | 125    | 23,7   | 40     | 16     | 24        |
| C601100320 | --- | M24 | 230    | 150    | 23,7   | 40     | 16     | 24        |
| C601100325 | --- | M24 | 250    | 150    | 23,7   | 40     | 16     | 24        |

2

FISSAGGIO E STAFFAGGIO



### Vite per cave a T per testa romboidale

Vite per cave a T per testa romboidale, filettatura rollata.

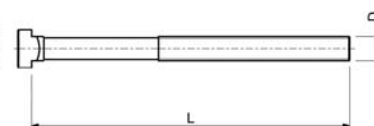

| Codice     | €   | D   | L (mm) | Cava (mm) |
|------------|-----|-----|--------|-----------|
| C603790120 | --- | M12 | 50     | 14        |
| C603790121 | --- | M12 | 80     | 14        |
| C603790122 | --- | M12 | 125    | 14        |
| C603790160 | --- | M16 | 63     | 18        |
| C603790161 | --- | M16 | 100    | 18        |
| C603790162 | --- | M16 | 160    | 18        |

| Codice     | €   | D   | L (mm) | Cava (mm) |
|------------|-----|-----|--------|-----------|
| C603791111 | --- | M20 | 50     | 22        |
| C603790201 | --- | M20 | 125    | 22        |
| C603790202 | --- | M20 | 200    | 22        |
| C603790240 | --- | M24 | 100    | 28        |
| C603790241 | --- | M24 | 125    | 28        |
| C603790242 | --- | M24 | 250    | 28        |



### Vite per cave a T testa maggiorata

Vite per cave a T con testa maggiorata in acciaio 42CrMoS4, **classe 10.9**, filettatura rollata.

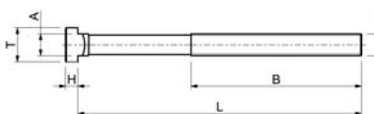

| Codice     | €   | D   | L (mm) | B (mm) | A (mm) | T (mm) | H (mm) | Cava (mm) |
|------------|-----|-----|--------|--------|--------|--------|--------|-----------|
| C601250005 | --- | M16 | 93     | 55     | 15,7   | 28     | 12     | 16        |
| C601250010 | --- | M16 | 120    | 75     | 15,7   | 28     | 12     | 16        |
| C601250015 | --- | M16 | 150    | 100    | 15,7   | 28     | 12     | 16        |
| C601250020 | --- | M16 | 200    | 125    | 15,7   | 28     | 12     | 16        |
| C601250025 | --- | M16 | 225    | 160    | 15,7   | 28     | 12     | 16        |
| C601250030 | --- | M16 | 250    | 160    | 15,7   | 28     | 12     | 16        |
| C601250035 | --- | M16 | 300    | 180    | 15,7   | 28     | 12     | 16        |
| C601250040 | --- | M18 | 120    | 75     | 17,7   | 35     | 14     | 18        |

| Codice     | €   | D   | L (mm) | B (mm) | A (mm) | T (mm) | H (mm) | Cava (mm) |
|------------|-----|-----|--------|--------|--------|--------|--------|-----------|
| C601250045 | --- | M18 | 150    | 100    | 17,7   | 35     | 14     | 18        |
| C601250050 | --- | M18 | 200    | 125    | 17,7   | 35     | 14     | 18        |
| C601250055 | --- | M18 | 225    | 150    | 17,7   | 35     | 14     | 18        |
| C601250060 | --- | M18 | 250    | 150    | 17,7   | 35     | 14     | 18        |
| C601250065 | --- | M18 | 300    | 190    | 17,7   | 35     | 14     | 18        |
| C601250070 | --- | M20 | 120    | 75     | 19,7   | 40     | 16     | 20        |
| C601250075 | --- | M20 | 150    | 100    | 19,7   | 40     | 16     | 20        |
| C601250080 | --- | M20 | 200    | 125    | 19,7   | 40     | 16     | 20        |

| Codice     | €   | D   | L (mm) | B (mm) | A (mm) | T (mm) | H (mm) | Cava (mm) |
|------------|-----|-----|--------|--------|--------|--------|--------|-----------|
| C601250085 | --- | M20 | 225    | 150    | 19,7   | 40     | 16     | 20        |
| C601250090 | --- | M20 | 250    | 150    | 19,7   | 40     | 16     | 20        |
| C601250095 | --- | M20 | 300    | 190    | 19,7   | 40     | 16     | 20        |
| C601250100 | --- | M24 | 120    | 75     | 23,7   | 44     | 20     | 24        |
| C601250105 | --- | M24 | 150    | 100    | 23,7   | 44     | 20     | 24        |

| Codice     | €   | D   | L (mm) | B (mm) | A (mm) | T (mm) | H (mm) | Cava (mm) |
|------------|-----|-----|--------|--------|--------|--------|--------|-----------|
| C601250110 | --- | M24 | 200    | 125    | 23,7   | 44     | 20     | 24        |
| C601250115 | --- | M24 | 225    | 150    | 23,7   | 44     | 20     | 24        |
| C601250120 | --- | M24 | 250    | 150    | 23,7   | 44     | 20     | 24        |
| C601250125 | --- | M24 | 300    | 190    | 23,7   | 44     | 20     | 24        |

2

### format Prigioniero singolo

Prigioniero singolo in acciaio 42CrMoS4, da M6-M12 classe 10.9 e M14-M24 classe 8.8, filettatura rollata, DIN 6379.

DIN 6379

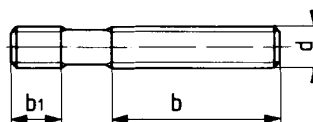

| Codice     | €   | d   | b (mm) | L (mm) | b1 (mm) |
|------------|-----|-----|--------|--------|---------|
| C609010001 | --- | M6  | 16     | 32     | 9       |
| C609010003 | --- | M6  | 30     | 40     | 9       |
| C609010005 | --- | M6  | 50     | 50     | 9       |
| C609010006 | --- | M8  | 20     | 63     | 11      |
| C609010007 | --- | M8  | 40     | 80     | 11      |
| C609010008 | --- | M8  | 63     | 40     | 11      |
| C609010011 | --- | M8  | 75     | 63     | 11      |
| C609010009 | --- | M8  | 100    | 80     | 11      |
| C609010010 | --- | M10 | 25     | 100    | 13      |
| C609010020 | --- | M10 | 50     | 125    | 13      |
| C609010030 | --- | M10 | 75     | 160    | 13      |
| C609010040 | --- | M10 | 122    | 200    | 13      |
| C609010050 | --- | M12 | 25     | 50     | 15      |
| C609010060 | --- | M12 | 32     | 63     | 15      |
| C609010070 | --- | M12 | 50     | 80     | 15      |
| C609010080 | --- | M12 | 63     | 100    | 15      |
| C609010090 | --- | M12 | 75     | 125    | 15      |
| C609010100 | --- | M12 | 122    | 200    | 15      |
| C609010110 | --- | M14 | 32     | 63     | 17      |
| C609010115 | --- | M14 | 50     | 80     | 17      |

| Codice     | €   | d   | b (mm) | L (mm) | b1 (mm) |
|------------|-----|-----|--------|--------|---------|
| C609010120 | --- | M14 | 63     | 100    | 17      |
| C609010125 | --- | M14 | 75     | 125    | 17      |
| C609010130 | --- | M14 | 100    | 160    | 17      |
| C609010135 | --- | M14 | 160    | 250    | 17      |
| C609010140 | --- | M16 | 32     | 63     | 19      |
| C609010150 | --- | M16 | 50     | 80     | 19      |
| C609010160 | --- | M16 | 63     | 100    | 19      |
| C609010170 | --- | M16 | 75     | 125    | 19      |
| C609010180 | --- | M16 | 100    | 160    | 19      |
| C609010190 | --- | M16 | 160    | 250    | 19      |
| C609010200 | --- | M20 | 32     | 80     | 27      |
| C609010210 | --- | M20 | 70     | 125    | 27      |
| C609010220 | --- | M20 | 122    | 200    | 27      |
| C609010230 | --- | M20 | 160    | 250    | 27      |
| C609010240 | --- | M20 | 190    | 315    | 27      |
| C609010250 | --- | M20 | 315    | 500    | 27      |
| C609010300 | --- | M24 | 45     | 100    | 35      |
| C609010310 | --- | M24 | 100    | 160    | 35      |
| C609010320 | --- | M24 | 160    | 250    | 35      |
| C609010330 | --- | M24 | 250    | 400    | 35      |



### Prigioniero singolo

Prigioniero singolo in acciaio 42CrMoS4, classe 10.9, filettatura rollata, DIN 6379.

DIN 6379



| Codice     | €   | D   | L (mm) | A (mm) | B (mm) |
|------------|-----|-----|--------|--------|--------|
| C601200005 | --- | M8  | 40     | 11     | 20     |
| C601200010 | --- | M8  | 63     | 11     | 40     |
| C601200015 | --- | M8  | 80     | 11     | 50     |
| C601200020 | --- | M8  | 100    | 11     | 63     |
| C601200025 | --- | M8  | 125    | 11     | 75     |
| C601200030 | --- | M8  | 160    | 11     | 100    |
| C601200035 | --- | M8  | 200    | 11     | 100    |
| C601200040 | --- | M10 | 50     | 13     | 25     |
| C601200045 | --- | M10 | 63     | 13     | 35     |
| C601200050 | --- | M10 | 80     | 13     | 50     |
| C601200055 | --- | M10 | 100    | 13     | 75     |
| C601200060 | --- | M10 | 120    | 13     | 75     |
| C601200065 | --- | M10 | 160    | 13     | 100    |
| C601200070 | --- | M10 | 200    | 13     | 125    |
| C601200075 | --- | M12 | 50     | 15     | 25     |
| C601200080 | --- | M12 | 63     | 15     | 32     |
| C601200085 | --- | M12 | 80     | 15     | 50     |
| C601200090 | --- | M12 | 100    | 15     | 63     |
| C601200095 | --- | M12 | 125    | 15     | 75     |
| C601200100 | --- | M12 | 160    | 15     | 100    |
| C601200105 | --- | M12 | 200    | 15     | 125    |
| C601200110 | --- | M12 | 225    | 15     | 160    |
| C601200115 | --- | M12 | 250    | 15     | 160    |
| C601200120 | --- | M14 | 63     | 17     | 32     |
| C601200125 | --- | M14 | 80     | 17     | 50     |
| C601200130 | --- | M14 | 100    | 17     | 63     |
| C601200135 | --- | M14 | 125    | 17     | 75     |
| C601200140 | --- | M14 | 160    | 17     | 100    |
| C601200145 | --- | M14 | 200    | 17     | 125    |
| C601200150 | --- | M14 | 225    | 17     | 160    |

| Codice     | €   | D   | L (mm) | A (mm) | B (mm) |
|------------|-----|-----|--------|--------|--------|
| C601200155 | --- | M14 | 250    | 17     | 160    |
| C601200160 | --- | M16 | 63     | 19     | 35     |
| C601200165 | --- | M16 | 80     | 19     | 50     |
| C601200170 | --- | M16 | 100    | 19     | 63     |
| C601200175 | --- | M16 | 125    | 19     | 75     |
| C601200180 | --- | M16 | 160    | 19     | 100    |
| C601200185 | --- | M16 | 200    | 19     | 125    |
| C601200190 | --- | M16 | 225    | 19     | 160    |
| C601200195 | --- | M16 | 250    | 19     | 160    |
| C601200200 | --- | M16 | 315    | 19     | 180    |
| C601200205 | --- | M18 | 80     | 23     | 50     |
| C601200210 | --- | M18 | 100    | 23     | 50     |
| C601200215 | --- | M18 | 125    | 23     | 75     |
| C601200220 | --- | M18 | 160    | 23     | 100    |
| C601200225 | --- | M18 | 200    | 23     | 125    |
| C601200230 | --- | M18 | 225    | 23     | 150    |
| C601200235 | --- | M18 | 250    | 23     | 150    |
| C601200240 | --- | M18 | 315    | 23     | 180    |
| C601200245 | --- | M20 | 80     | 27     | 30     |
| C601200250 | --- | M20 | 125    | 27     | 70     |
| C601200255 | --- | M20 | 160    | 27     | 100    |
| C601200260 | --- | M20 | 200    | 27     | 125    |
| C601200265 | --- | M20 | 225    | 27     | 160    |
| C601200270 | --- | M20 | 250    | 27     | 160    |
| C601200275 | --- | M20 | 315    | 27     | 200    |
| C601200280 | --- | M22 | 100    | 31     | 45     |
| C601200285 | --- | M22 | 120    | 31     | 63     |
| C601200290 | --- | M22 | 160    | 31     | 100    |
| C601200295 | --- | M22 | 200    | 31     | 125    |
| C601200300 | --- | M22 | 225    | 31     | 160    |